

63.88 ACRES
TRACT J
FATE I-30
COMMERCIAL LP
VOL 4167, PG 151
O.P.R.R.C.T.

NOTE: ALL 4' SIDEWALK BUILT BY HOME BUILDER SHALL REQUIRE A 5' X 5' TURNAROUND EVERY 200' OF SIDEWALK.

NOTES:

1. NO STRUCTURES (VALVES, MANHOLES, ETC.) SHALL BE LOCATED IN THE CURB RAMPS OR CURBS.
2. SIDEWALKS/TRAILS SHALL BE NO CLOSER THAN 2' FROM BACK OF CURB.
3. ALL BARRIER FREE RAMPS PER CITY OF FATE STANDARDS UNLESS OTHERWISE NOTED, SEE SHEET 47 FOR STANDARD RAMP CONSTRUCTION DETAIL.
4. TXDOT BARRIER FREE RAMPS TO INCLUDE CITY OF FATE RED BRICK PAVERS THAT CONSIST OF RAISED TRUNCATED DOMES WITH A DIA OF 0.9 IN. (23 MM), A HEIGHT OF NOMINAL 0.2 IN. (5 MM) AND THE CENTER TO CENTER SPACING NOMINAL 2.35 IN. (60 MM) PER CITY OF FATE STANDARDS, SEE SHEET 47 FOR TYPICAL RAMP CONSTRUCTION DETAIL.

SIDEWALK LEGEND

- 5' SIDEWALKS & ADA RAMPS BY DEVELOPER
- 8' SIDEWALK/TRAIL BY DEVELOPER
- 5' EXISTING SIDEWALK
- 8' SIDEWALK/TRAIL BY SEPARATE PLANS
- 8' FUTURE SIDEWALK/TRAIL
- 6' MASONRY SCREENING WALL

- BENCHMARKS:
1. SQUARE CUT IN NORTH CORNER OF HEADWALL ON EAST SIDE OF F.M. 551 APPROXIMATELY 625 FEET NORTH OF MILLER LANE ELEVATION = 586.55
 2. SQUARE CUT ON TOP OF ABUTMENT (WALL) ON THE SOUTHWEST CORNER OF BRIDGE AT INTERSECTION OF F.M. 551 AND I.H. 30 ELEVATION = 602.48

REV	DATE	BY	REVISION
REVISIONS			

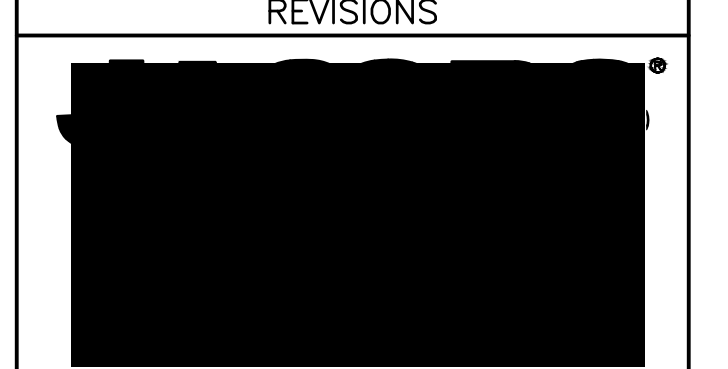

OPEN SPACE, TRAIL, & SCREENING PLAN

PHASE 2C

CITY OF FATE
ROCKWALL COUNTY, TEXAS

DESIGNED: LOCKLEAR	PROJECT NUMBER: WFXM8901
DRAWN: FREEMAN	DATE: FEB 2017
APPROVED: KESSLER	SCALE

PRELIMINARY FOR REVIEW ONLY These documents are for Design Review and not intended for Construction, Bidding or Permit purposes. They are subject to change without notice.	HORIZ: 1"=60' VERT: N/A
--	----------------------------

REV DATE:	SHEET
	41
	OF 54 SHEETS

FEBRUARY 2017

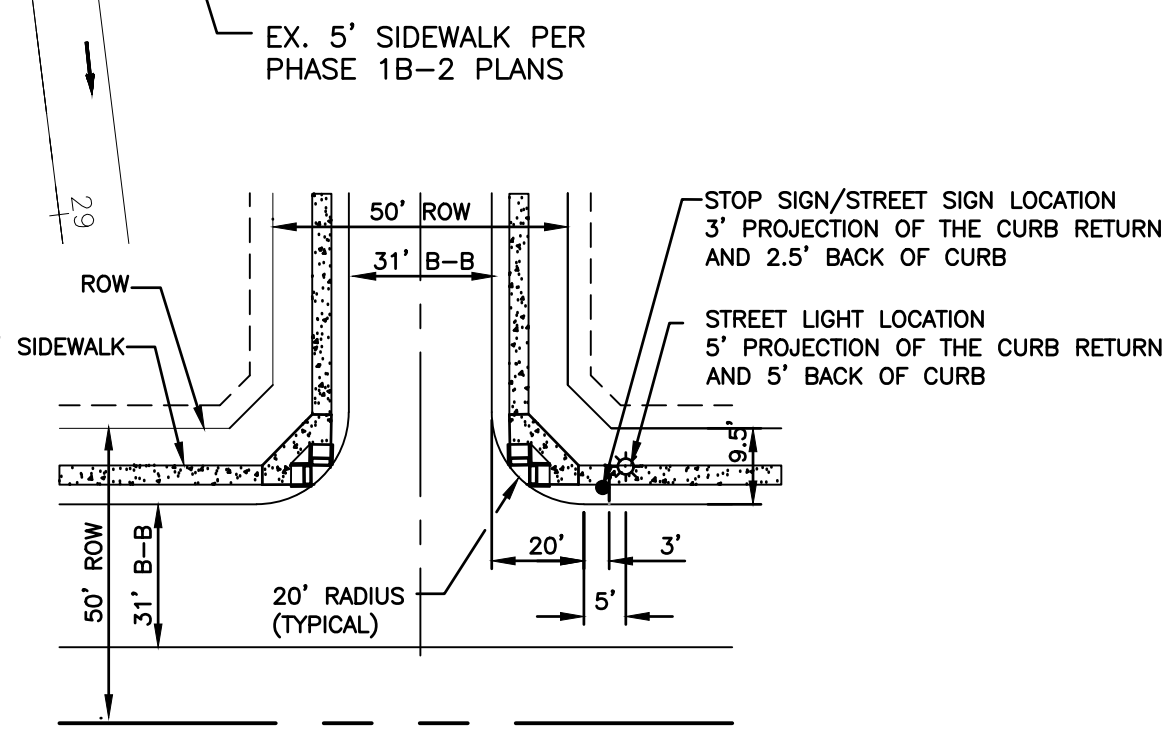
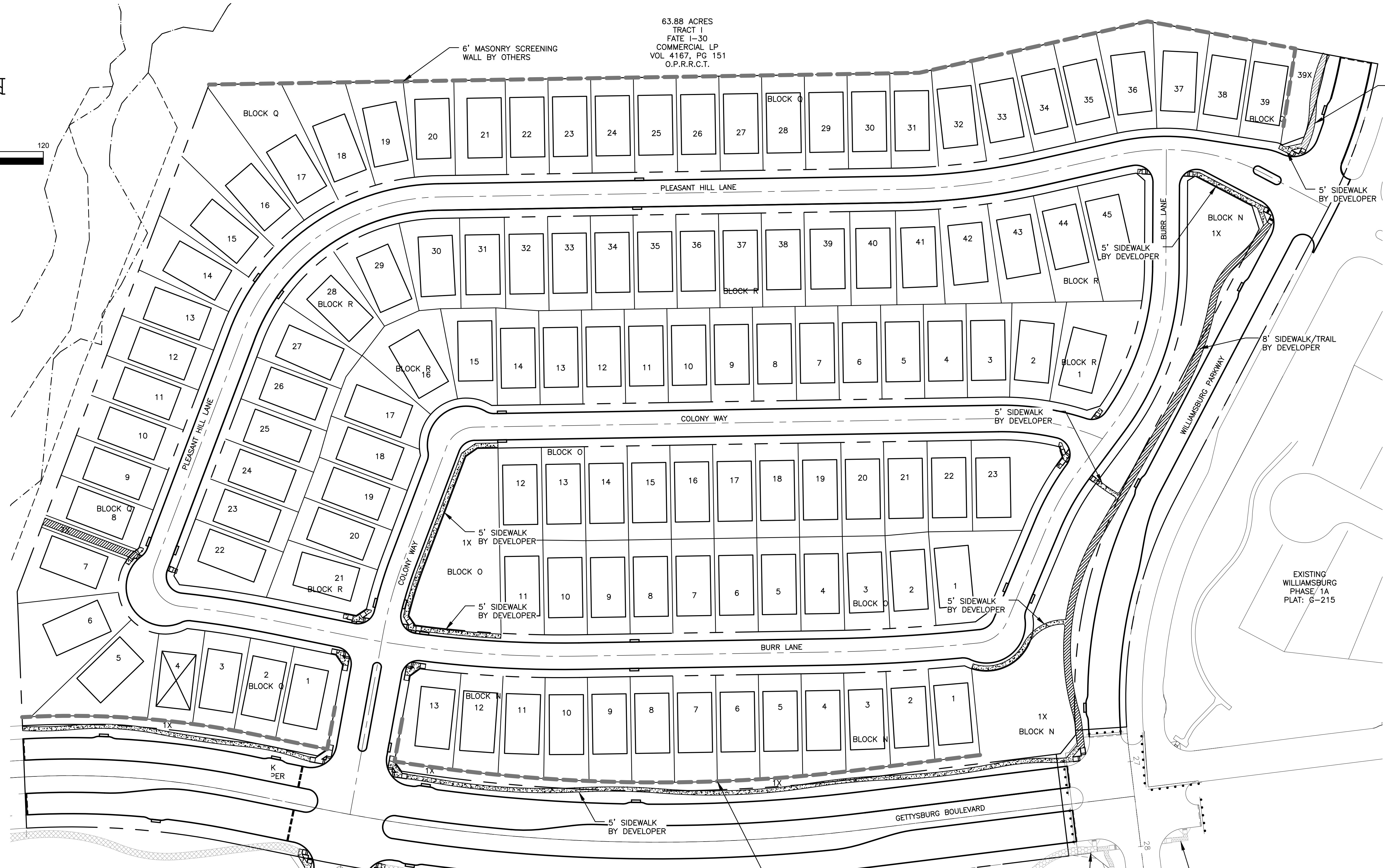

STREET LIGHT & STOP SIGN TYPICAL LOCATION
NTS